

# Zoar Evangelical Lutheran Church

190 SW Third Avenue  
Canby, Oregon 97013  
[www.zoarlutheran.org](http://www.zoarlutheran.org) ♦ [zoar@canby.com](mailto:zoar@canby.com)  
503.266.4061

*Capital Stewardship Campaign*





## A WORD FROM OUR PASTOR

Dear Brothers and Sisters in Christ,

It is exciting that we have reached the point of energetically moving forward with our capital campaign so that we can begin construction of Phase Two of our building program as soon as possible. I am grateful to all of you for being involved, as you are able in this endeavor.

*Be imitators of God, as beloved children, and live a life of love, as Christ loved us and gave himself up for us, as a fragrant offering and sacrifice to God.*

Ephesians 5:1

Zoar's rich history has included so many people who have done so much to provide the buildings needed to undergird and facilitate the varied ministries of the Gospel carried on through this congregation. This letter serves to introduce the campaign booklet and to invite you thoughtfully and prayerfully to consider how you might continue to support our ministries today and for years to come.

As you may know, our theme is, **Fellowship Together in Christ**. This theme stresses the fact that we can accomplish far more when we are working together than we ever could by ourselves. While Christian faith must be deeply personal, it can never be private. Christ calls us into fellowship with one another, and makes that fellowship possible through what he has done for us all through the cross and resurrection. When our fellowship is in him, we are drawn together into a body that carries forth his mission of bringing saving grace into people's lives.

So, our first campaign theme verse is I John 1:3: *We proclaim to you what we have seen and heard, so that you also may have fellowship with us, and our fellowship is with the Father and with his son, Jesus Christ.* Our second theme verse builds upon the first. It is wonderful to have this fellowship in Christ, but we are also called by God to do more than simply enjoy what we have been given. We are challenged to put this wonderful grace into action. This second verse shows how that can happen: *Be imitators of God as beloved children, and live a life of love, as Christ loved us and gave himself up for us, as a fragrant offering and sacrifice to God* (Ephesians 5:1).

I invite you to allow these words of Christ to dwell in you richly in light of our theme, **Fellowship Together in Christ**. How can we "proclaim what we have seen and heard"? How can we live as life of loving sacrifice, modeled on Christ? What will Zoar's, and our future, look like? That will have much to do with how we respond to such questions.

God bless you as we continue together on this journey of grace. Our faithfulness today will bring joy now and help shape tomorrow as well. God's grace and peace!

*Pr. Nick Doversberger*

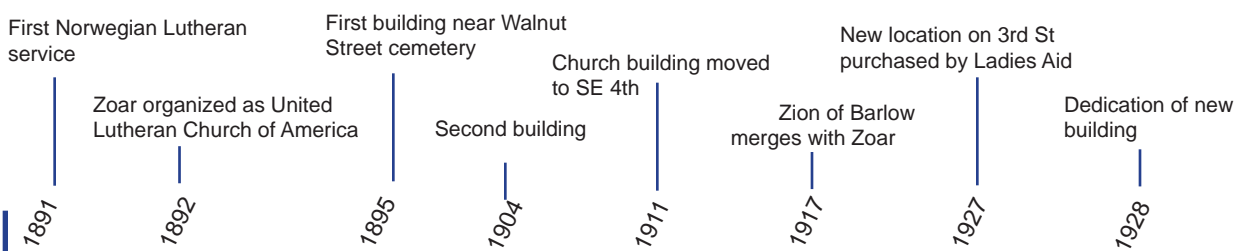

**A LONG AND RICH HISTORY**

# 2020 VISION



**VISION IS ESSENTIAL TO THE CHURCH.** It is dynamic, not static. Over time, the vision must be renewed, adapted, and adjusted to the cultural context in which the congregation lives. The change takes place only at the margins of the vision, not at its core. The core—the Great Commission—does not change. The details of the vision and the words used to convey them will change. The vision, therefore, provides us with a preferred picture of what Zoar Evangelical Lutheran Church will look like as it is realized in the community. By its very nature, the meaning of Zoar is “a small place of refuge.”

**ZOAR WILL BE AN EFFECTIVE MINISTRY,** which flows out of a spiritual intimacy. As the passion for Christ increases, the growing “homecoming” atmosphere of the church and the fruit of its ministry will be very evident. People will wholeheartedly welcome each other and every guest with genuine care and concern. Spending daily time with God in prayer, devotion and Bible study will be a rewarding joy for many people. Confession, repentance and absolution centered in grace will be a significant natural part of each member’s life.

**ZOAR WILL BE A CONGREGATION WITH A CONVICTION** that God acts in powerful ways. The nurturing of living faith and active discipleship is central to this congregation’s vision and pastoral ministry. Everyone will be challenged to integrate his or her faith into all areas of life. Congregational and personal prayer will be seen as a significant sharing ministry, not just as preparation for ministry. Members will openly share how God’s transforming work is alive in their own lives. It will raise up its own future church workers among its own membership for mission and ministry both at home and abroad. As an established and leading congregation in the community, Zoar will seek to share the Gospel more effectively with others.

**ZOAR WILL PROMOTE A GODLY VISION,** attained through a hope-filled faith, which relies on God’s promises, grace and power and responds in service to God’s love. Members will be involved based on their spiritual gifts. Leaders will encourage and empower people to seek out ways to serve and be served. The congregation will be known in the community as one, which exhibits the fruits of the Spirit as it ministers to a diversity of people. The Congregation will seek ways to provide service and outreach through dynamic programs, caring people, modern facilities, and inspiring worship opportunities at its own campus as well as satellite sites in the area.

## MISSION

*Responding in  
Service to God’s Love*

*We proclaim to you what  
we have seen and heard,  
so that you also may  
have fellowship with us.  
And our fellowship is with  
the Father and with his  
Son, Jesus Christ.*

1 John 1:3

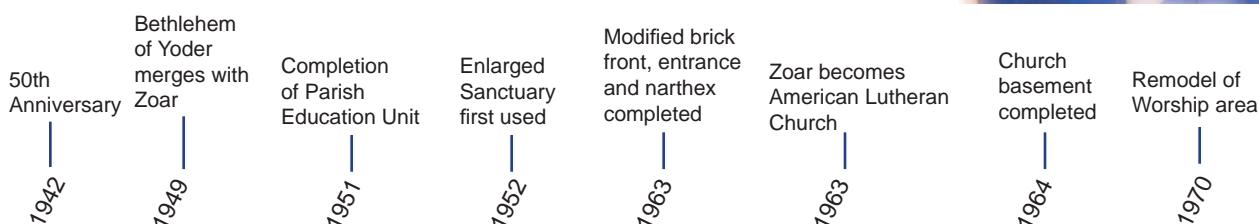



# Campaign for Phase II

*Never be lacking in zeal, but keep your spiritual fervor, serving the Lord. Be joyful in hope, patient in affliction, faithful in prayer.*

Romans 12:11-12

Phase II of the building project will enable our members and friends to be more passionate in their own spirituality to better share and grow in the Word. This building remains a tool to carry out ministry work and includes a multi-purpose room, narthex (lobby), commercial kitchen and storage area. It will enable Zoar to expand and offer more ministries to meet the growing needs of our members. It will enable Zoar to better reach out to the community so more may hear the message of Jesus and come to saving faith in Him.

The longer people reach toward maturity in Christ, the more they come to see a fundamental truth about His kingdom - there is room for everyone! Over the past several years the congregation has come together to support the concept of a single floor master building plan. Phase I has already been built with Phase II in mind (restrooms, underground, electrical and mechanical upgrades, etc.), therefore reducing some of the infrastructure costs. Phase II will allow the congregation to retain the heritage of the old church by utilizing portions of the current sanctuary in the new construction. It already has been determined that pouring more money into maintaining, renovating or moving the current sanctuary would not be wise stewardship.

Now there is an opportunity for you to join and participate in this exciting venture - taking ownership in **Fellowship Together in Christ!** This, along with regular annual offerings, will have a significant impact on the resources available for programs, facilities and ministry!



View from the NE showing Phase II attached to an already completed Phase I. Phase III, a new sanctuary, will someday round out the entire project.

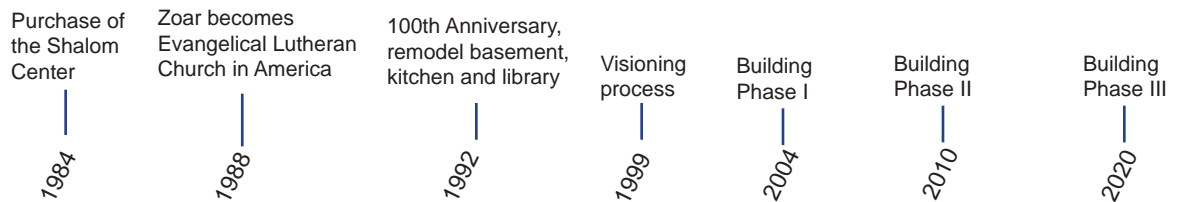

# Campaign Goal and Projected Finances



With God's blessing we will reach one of the following goals:

- Miracle Goal:** \$750,000
- Challenge Goal:** \$600,000
- Commitment Goal:** \$450,000

These amounts are over and above regular annual offerings during the next three years.

The Readiness Study prior to the Campaign indicated that these goals are within reach. In the first campaign, the members of Zoar committed \$728,000 and took out a \$290,000 loan to complete Phase I. By the grace of God, that loan was completely paid off in 39 months!

*Commit to the Lord whatever you do and your plans will succeed.*

Proverbs 16:3

*For no one can lay any foundation other than the one already laid, which is Jesus Christ.*

I Corinthians 3:11

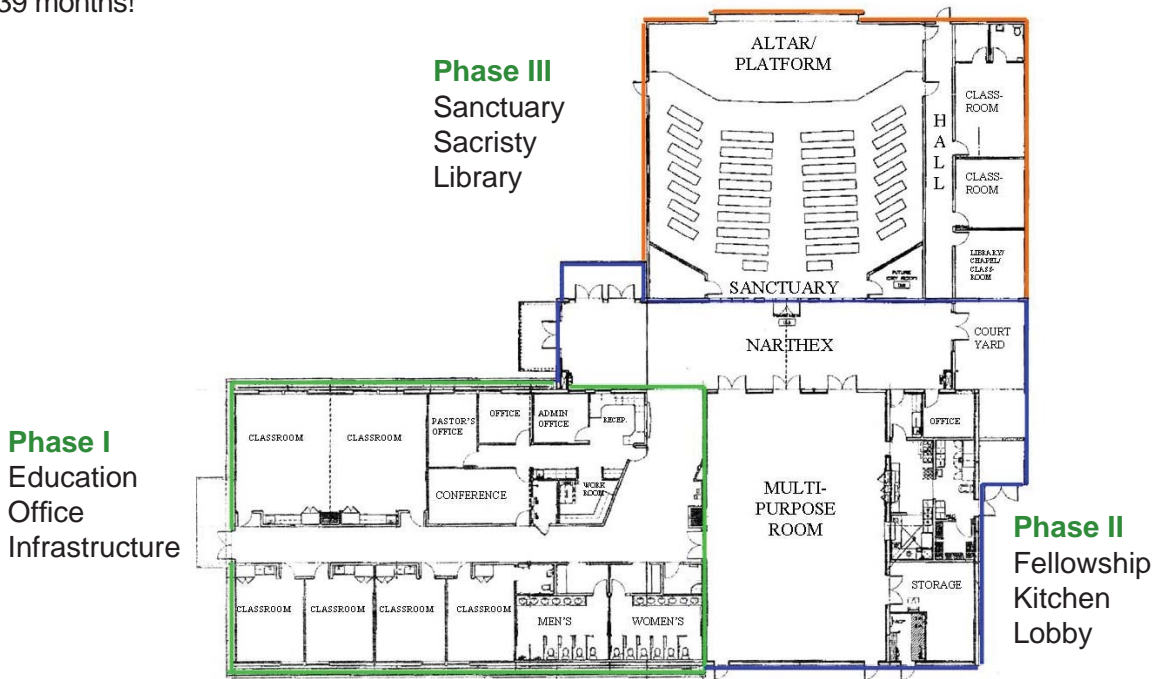

<b>EXPENSE</b>	ESTIMATED CONSTRUCTION COSTS	-\$900,000	
	<i>(Includes campaign, architect, permits, and construction)</i>		}
	FURNISHINGS & FINISHES	-\$100,000	
<i>(Includes commercial kitchen, tables and chairs, technology, etc.)</i>			
<b>INCOME</b>	NEEDED IN CAPITAL CAMPAIGN	+\$600,000 to \$450,000	
	<i>(The Challenge and Commitment levels)</i>		}
	NEEDED IN FURNISHINGS GIFTS	+\$100,000	
<i>(Opportunity for friends and former members)</i>			
	MISSION INVESTMENT FUND LOAN	+\$300,000 to \$450,000	
<i>(Maximum amount available with increased giving and growth)</i>			

Few families would be able to consider funding such a project on their own, but together, by the grace of God, in Christian fellowship, it can happen! Then we will anticipate the October 2011 deadline to pull building permits and avoid the costly System Development Charges.



# Grow in Faith and Generosity

Our Fellowship Together in Christ Stewardship campaign presents each of us with an opportunity to renew our commitment to God's service and to grow in Christian stewardship. Both manifest our love for Christ and help us to be more spiritually passionate in our daily life. As we evaluate our current giving to Zoar, we recognize the bounty of God's gifts. Our generous response reflects our gratitude. *"Christ's love compels us...."*

*How can I repay my God for all the Lord's goodness to me?*

Psalm 116:12

*God loves a cheerful giver.*

2 Corinthians 9:7

## "Equal Sacrifice, Not Equal Giving"

It is your financial support to our church that allows us to perform the mission and ministry that God intends. This will mean some sacrifice for all of us. To "sacrifice" means to willingly give the best we have for a greater purpose. While we cannot all give the same amount, we can all make sacrifices. In doing so everyone is involved. The biblical understanding of stewardship is a faith gift: we give generously out of love to God based on our faith and trust in our God.

God gives to us generously. He gives us everything we have; he gave his Son to be our Savior. He compels us to give from thankful, cheerful hearts. For the people of God, giving is an act of worship and an act of faith. All our giving is a response to what God has first given to us.

Financial support is our opportunity to return to God a portion of the many gifts we have received from him. When we give to God, we are acknowledging that we know what is important in life – that we realize there are no self-made individuals and that whatever we have, whatever we give, whatever we have accomplished are, in fact, gifts from God.

## How Much Should I Give?

We begin our giving by considering the opportunity to increase our regular offerings first. Then we consider the **Fellowship Together in Christ** campaign as our opportunity to participate in God's mission, over and above our regular offerings, in this time and place, while creating a legacy that will continue for generations to come.

Therefore, your campaign leadership team boldly asks each household to prayerfully commit itself to the most generous level of its financial ability and spiritual gratitude. Let our Father's love show you the way!



# Six Steps for Giving



**Step 1.** In order to reach our Campaign goal, we ask all of our members and friends to pray for the Savior's help as they consider one of these types of Faith Gifts. **Select a COMMITMENT level on the tree, over and above regular offerings** - your first priority, which is realistic for you and your family over three years.

*And God is able to give you more than you need, so that you will...always have all you need for yourselves and more than enough for every good cause.*  
2 Corinthians 9:8

This chart represents the number and type of gifts needed to reach the Miracle Goal over 3 years.

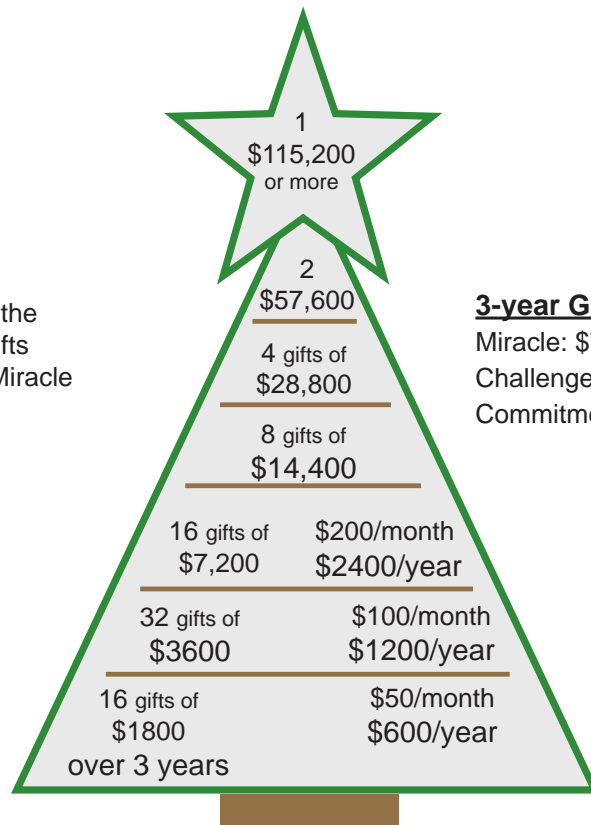

### 3-year Goals

Miracle: \$750,000  
Challenge: \$600,000  
Commitment: \$450,000

**Step 2.** It would be difficult for most people to make a special gift solely out of cash from regular income each year. Perhaps God has blessed you a measure of love and grace through some **special income provisions**. Is there anything on the following list that would **CHALLENGE** you and your family to move up one level on the gift tree?

- ✓ Delay a major purchase/reduce spending
- ✓ Thrivent "Choice" or 'charity' garage sale
- ✓ Stocks, bonds, savings, bonus, tax refund
- ✓ Temporary job during campaign
- ✓ In lieu of Christmas or birthday gifts
- ✓ Extended family combined gift

**Step 3.** Perhaps God has called you to be a steward of extraordinary blessings sometimes called "assets." Is there anything on the following list that would enable you and your family to **move up even another level on the gift tree** and help Zoar reach the unexpected, unanticipated **MIRACLE** level?

- ✓ Cars, cycles, boats, RV's, farm equipment
- ✓ Inheritance, pension fund, annuities
- ✓ Advance cash gift from will or estate plan
- ✓ Land, retirement lots, cabins, business
- ✓ Collection (coins, dolls, cards, stamps)
- ✓ Loan on life insurance or home equity



# LORD, WHAT DO YOU WANT TO DO THROUGH ME TO ACCOMPLISH YOUR WILL FOR THIS MINISTRY?

*Now finish the work, so your eager willingness to do it may be matched by your completion of it, according to your means.*

2 Corinthians 8:12

**Step 4.** Of course, please give as God leads you. Pray for God's guidance. For Christians, all of our gift-giving decisions are motivated by the love God has shown in what Jesus our Savior has done for us. Faithful stewards believe that it is a privilege to support the work of gospel ministry with the conviction that we cannot give more to God than what he promises to give to us. Whatever amount you decide to give in faith over the next three years, including your regular offerings, is a gift that pleases God. It is a gift that will reach many through the word of God as it is taught and discussed in the ministries that are offered at Zoar.

Please join your fellow members and friends at Zoar in the following prayer:

Dear Lord, as you were generous with your love by going to the cross as our substitute and paying in full the price for our salvation with your lifeblood, please move me to respond to our Fellowship Together in Christ campaign in a generous and trusting way. Teach me that sharing the gifts you have given me to benefit the souls of others is part of my spiritual act of worship and a way to put my faith in you, Jesus, into action. Always keep me focused on you. Amen.

**Step 5. Complete the Promise Card.** The Promise Card is a way to record your promise on paper and is a planning and confidential tool. It is an indication of your intent to support ministry through this capital stewardship campaign, increased regular offerings, and estate planning.

**Step 6. Seal your Promise Card in the designated envelope and bring or mail it to church.** Promise cards will be laid on the altar on Commitment Sunday during the worship service. Those who wish may make their promise gift prior to this date by sending it to the church office or giving it to the Campaign Financial Secretary. Each successive year, your Promise Card will be returned to you for updating.



**Thank you** for taking the time to take this stewardship journey and learn ways to participate in this unique opportunity to expand facilities and ministry to others! If you have any questions, please contact one of the Campaign Leadership Team members:

- John Kimball and Ann Skoe, Co-Chair
- Pastor Nick Doversberger, Spiritual Encouragement
- Connie Tye, Pre-School Liaison
- Paul Rothi, Leadership Gifts
- Mary Eastman and Pam Hygelund, Communications
- Candi Millar, Gathering Hosts & Telephoners
- Ron Berg, Building Task Force Representative
- Donna Pottratz and Don Knight, Financial Secretaries
- Tom Grunow, Cornerstone Stewardship Ministry Consultant